



# POLEAS DENTADAS PARA TAPER PARA CORREAS SYNCHROBELT® - "HTD"

## SYNCHROBELT® "HTD" TIMING BELTS PULLEYS FOR TAPER BUSHES

### 5M

PASO 5 mm

PARA ANCHO DE CORREA 15 mm

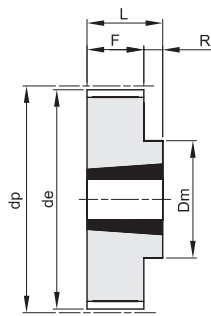

10

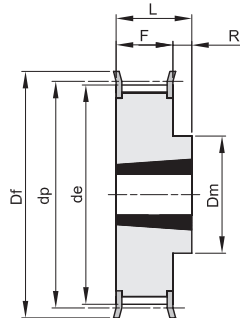

10F

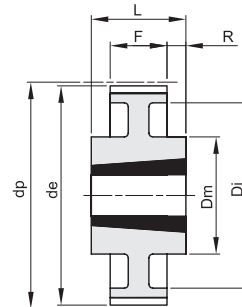

13

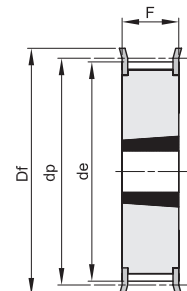

15F

Material: Acero (St)

codice	tipo	materiale	denti	bussola	foro max	dp	de	Df	Dm	Di	F	L	R	n° flangia	Kg.
TL 34 5M 15	15F	St	34	1008	25	54,11	52,97	57			22	22		213	0,20
TL 36 5M 15	15F	St	36	1108	25	57,30	56,15	60			22	22		214	0,25
TL 38 5M 15	15F	St	38	1108	25	60,48	59,34	66			22	22		216	0,30
TL 40 5M 15	15F	St	40	1108	25	63,66	62,52	71			22	22		217	0,35
TL 44 5M 15	15F	St	44	1108	25	70,03	68,89	75			22	22		218	0,40
TL 48 5M 15	10F	St	48	1210	32	76,39	75,25	83	59		22	25	3	219	0,46
TL 56 5M 15	10F	St	56	1210	32	89,13	87,99	93	70		22	25	3	222	0,60
TL 64 5M 15	10F	St	64	1210	32	101,86	100,72	106	80		22	25	3	224	0,80
TL 72 5M 15	10	St	72	1610	42	114,59	113,45		92		22	25	3		1,20
TL 80 5M 15	10	St	80	1610	42	127,32	126,18		92		22	25	3		1,76
TL 90 5M 15	10	St	90	1610	42	143,24	142,10		92		22	25	3		2,32
TL112 5M 15	10	St	112	2012	50	178,25	177,11		110		20	32	12		3,72
TL136 5M 15	13	St	136	2012	50	216,45	215,31		110	199	20	32	6		3,82



# POLEAS DENTADAS PARA TAPER PARA CORREAS SYNCHROBELT® - "HTD" SYNCHROBELT® "HTD" TIMING BELTS PULLEYS FOR TAPER BUSHES

## 8M

### PASO 8 mm

PARA ANCHO DE CORREA 20 mm

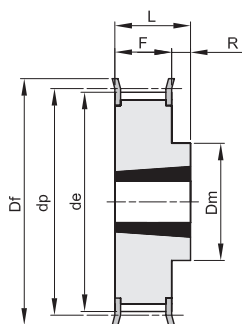

10F

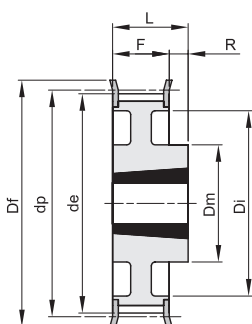

11F

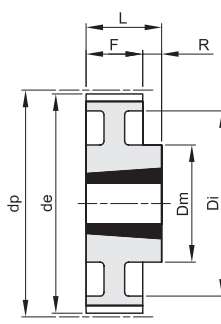

11

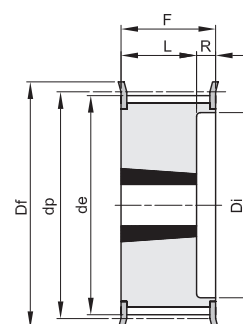

16F

Material: Acero (St)

Material: Fundición (GG)

codice	tipo	materiale	denti	bussola	foro max	dp	de	Df	Dm	Di	F	L	R	n° flangia	Kg.
TL 22 8M 20	16F	St	22	1008	25	56,02	54,65	60		37	28	22	6	308	0,25
TL 24 8M 20	16F	St	24	1108	25	61,11	59,74	66		44	28	22	6	310	0,30
TL 26 8M 20	16F	St	26	1108	25	66,21	64,84	71		45	28	22	6	311	0,36
TL 28 8M 20	16F	St	28	1108	25	71,30	70,08	75		50	28	22	6	312	0,45
TL 30 8M 20	16F	St	30	1108	25	76,39	75,13	83		58	28	22	6	314	0,55
TL 32 8M 20	16F	St	32	1610	42	81,49	80,16	87		63	28	25	3	315	0,43
TL 34 8M 20	16F	St	34	1610	42	86,58	85,21	91		64	28	25	3	316	0,57
TL 36 8M 20	16F	St	36	1610	42	91,67	90,30	98		68	28	25	3	319	0,70
TL 38 8M 20	16F	St	38	1610	42	96,77	95,39	103		72	28	25	3	320	0,82
TL 40 8M 20	16F	St	40	1610	42	101,86	100,49	106		76	28	25	3	321	1,10
TL 44 8M 20	10F	St	44	2012	50	112,05	110,67	119	92		28	32	4	325	1,20
TL 48 8M 20	10F	St	48	2012	50	122,23	120,86	127	96		28	32	4	327	1,65
TL 56 8M 20	10F	St	56	2012	50	142,60	141,23	148	110		28	32	4	333	2,50
TL 64 8M 20	11F	St	64	2012	50	162,97	161,60	168	110	137	28	32	4	338	2,60
TL 72 8M 20	11F	St	72	2012	50	183,35	181,97	192	110	158	28	32	4	340	3,40
TL 80 8M 20	11	GG	80	2012	50	203,72	202,35		110	180	28	32	4		3,60
TL 90 8M 20	11	GG	90	2012	50	229,18	227,81		110	204	28	32	4		4,10



# POLEAS DENTADAS PARA TAPER PARA CORREAS SYNCHROBELT® - "HTD"

## SYNCHROBELT® "HTD" TIMING BELTS PULLEYS FOR TAPER BUSHES

### 8M

#### PASO 8 mm

PARA ANCHO DE CORREA 30 mm

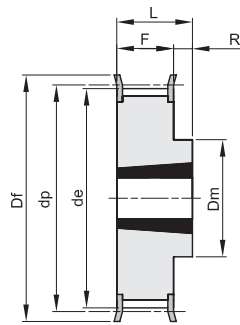

10F

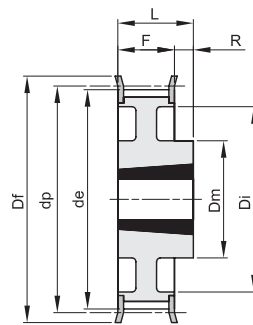

11F

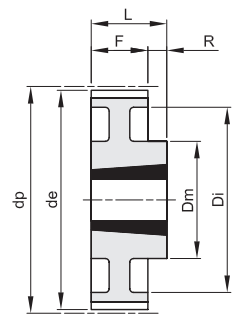

11

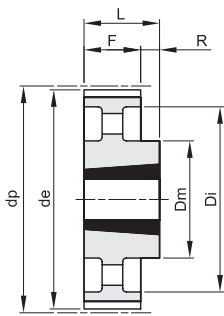

12

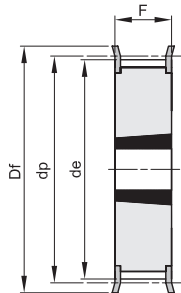

15F

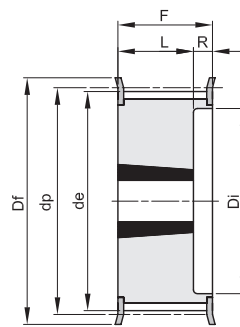

16F

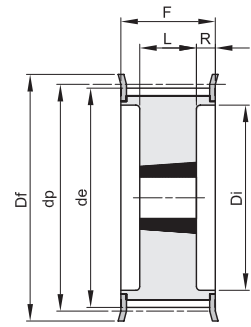

18F

Material: Acero (St)

Material: Fundición (GG)

codice	tipo	materiale denti	bussola	foro max	dp	de	Df	Dm	Di	F	L	R	n° flangia	Kg.	
TL 22 8M 30	16F	St	22	1008	25	56,02	54,65	60	37	38	22	16	308	0,33	
TL 24 8M 30	16F	St	24	1108	25	61,11	59,74	66	44	38	22	16	310	0,40	
TL 26 8M 30	16F	St	26	1108	25	66,21	64,84	71	44	38	22	16	311	0,45	
TL 28 8M 30	16F	St	28	1210	32	71,30	70,08	75	50	38	25	13	312	0,50	
TL 30 8M 30	15F	St	30	1615	42	76,39	75,13	83		38	38		314	0,55	
TL 32 8M 30	15F	St	32	1615	42	81,49	80,16	87		38	38		315	0,60	
TL 34 8M 30	15F	St	34	1615	42	86,58	85,21	91		38	38		316	0,80	
TL 36 8M 30	15F	St	36	1615	42	91,67	90,30	98		38	38		319	1,00	
TL 38 8M 30	15F	St	38	1615	42	96,77	95,39	103		38	38		320	1,10	
TL 40 8M 30	15F	St	40	1615	42	101,86	100,49	106		38	38		321	1,34	
TL 44 8M 30	18F	St	44	2012	50	112,05	110,67	119	86	38	32	3	325	1,30	
TL 48 8M 30	18F	St	48	2012	50	122,23	120,86	127	90	38	32	3	327	1,80	
TL 56 8M 30	18F	St	56	2012	50	142,60	141,23	148	110	38	32	3	333	3,80	
TL 64 8M 30	10F	St	64	2517	60	162,97	161,60	168	125	38	45	7	338	4,30	
TL 72 8M 30	11F	St	72	2517	60	183,35	181,97	192	125	158	38	45	7	340	4,40
TL 80 8M 30	11	GG	80	2517	60	203,72	202,35		125	180	38	45	7	4,65	
TL 90 8M 30	11	GG	90	2517	60	229,18	227,81		125	204	38	45	7	5,80	
TL112 8M 30	12	GG	112	2517	60	285,21	283,83		125	254	38	45	7	6,20	
TL144 8M 30	12	GG	144	2517	60	366,69	365,32		125	336	38	45	7	9,00	



# POLEAS DENTADAS PARA TAPER PARA CORREAS SYNCHROBELT® - "HTD"

## SYNCHROBELT® "HTD" TIMING BELTS PULLEYS FOR TAPER BUSHES

### 8M

#### PASO 8 mm

PARA ANCHO DE CORREA 50 mm

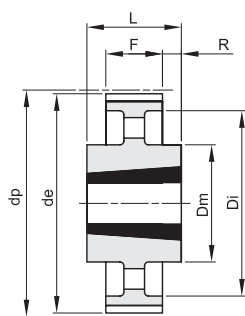

14

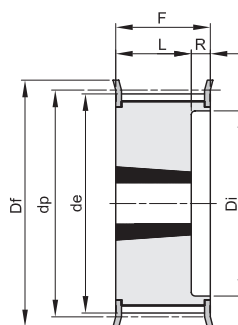

16F

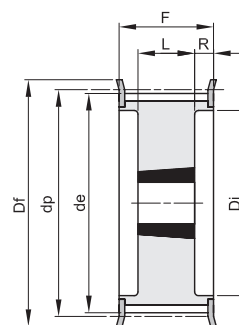

18F

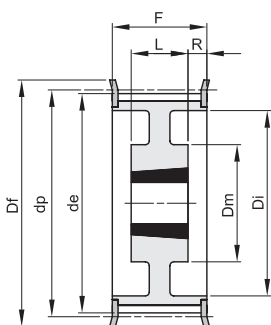

19F

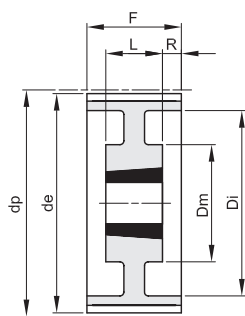

19

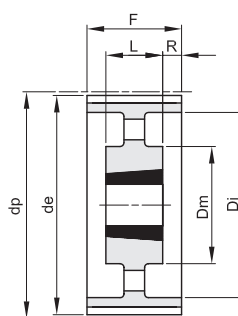

20

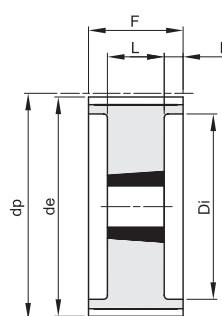

18

Material: Acero (St)

Material: Fundición (GG)

codice	tipo	materiale denti	bussola	foro max	dp	de	Df	Dm	Di	F	L	R	n° flangia	Kg.	
TL 28 8M 50	16F	St	28	1210	32	71,30	70,08	75	50	60	25	35	312	0,60	
TL 30 8M 50	16F	St	30	1615	42	76,39	75,13	83	58	60	38	22	314	0,65	
TL 32 8M 50	16F	St	32	1615	42	81,49	80,16	87	63	60	38	22	315	0,80	
TL 34 8M 50	16F	St	34	1615	42	86,58	85,21	91	65	60	38	22	316	1,08	
TL 36 8M 50	16F	St	36	1615	42	91,67	90,30	98	68	60	38	22	319	1,35	
TL 38 8M 50	16F	St	38	1615	42	96,77	95,39	103	72	60	38	22	320	1,65	
TL 40 8M 50	18F	St	40	2012	50	101,86	100,49	106	80	60	32	14	321	1,70	
TL 44 8M 50	18F	St	44	2012	50	112,05	110,67	119	86	60	32	14	325	1,80	
TL 48 8M 50	18F	St	48	2012	50	122,23	120,86	127	95	60	32	14	327	2,35	
TL 56 8M 50	18F	St	56	2517	60	142,60	141,23	148	116	60	45	7,5	333	3,35	
TL 64 8M 50	18F	St	64	2517	60	162,97	161,60	168	136	60	45	7,5	338	4,90	
TL 72 8M 50	19F	St	72	2517	60	183,35	181,97	192	125	158	60	45	7,5	340	6,90
TL 80 8M 50	18	GG	80	3020	75	203,72	202,35		180	60	51	4,5		8,90	
TL 90 8M 50	19	GG	90	3020	75	229,18	227,81		160	204	60	51	4,5	9,90	
TL112 8M 50	19	GG	112	3020	75	285,21	283,83		170	254	60	51	4,5	12,10	
TL144 8M 50	20	GG	144	3020	75	366,69	365,32		170	336	60	51	4,5	15,40	
TL168 8M 50	14	GG	168	3525	90	427,81	426,44		198	395	60	65	2,5	22,80	
TL192 8M 50	14	GG	192	3525	90	488,92	487,55		198	455	60	65	2,5	26,50	



# POLEAS DENTADAS PARA TAPER PARA CORREAS SYNCHROBELT® - "HTD" SYNCHROBELT® "HTD" TIMING BELTS PULLEYS FOR TAPER BUSHES

## 8M

### PASO 8 mm

PARA ANCHO DE CORREA 85 mm

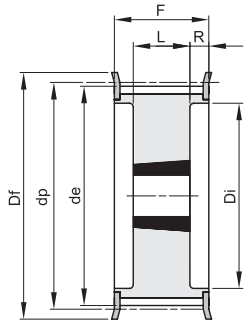

18F

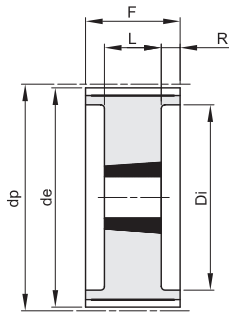

18

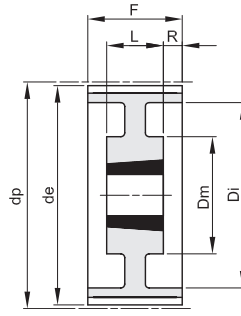

19

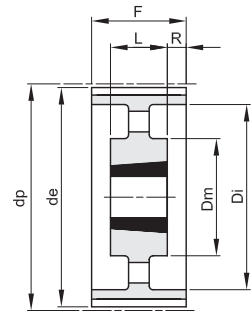

20

Material: Acero (St)

Material: Fundición (GG)

codice	tipo	materiale	denti	bussola	foro max	dp	de	Df	Dm	Di	F	L	R	n° flangia	Kg.
TL 34 8M 85	18F	St	34	1615	42	86,58	85,22	91		65	95	38	28,5	316	1,50
TL 36 8M 85	18F	St	36	1615	42	91,67	90,30	98		68	95	38	28,5	319	1,90
TL 38 8M 85	18F	St	38	1615	42	96,77	95,39	103		72	95	38	28,5	320	2,20
TL 40 8M 85	18F	St	40	2012	50	101,86	100,49	106		80	95	32	31,5	321	1,90
TL 44 8M 85	18F	St	44	2012	50	112,05	110,67	119		86	95	32	31,5	325	2,30
TL 48 8M 85	18F	St	48	2517	60	122,23	120,86	127		97	95	45	25	327	2,70
TL 56 8M 85	18F	St	56	2517	60	142,60	141,23	148		116	95	45	25	333	4,50
TL 64 8M 85	18F	St	64	2517	60	162,97	161,60	168		136	95	45	25	338	6,30
TL 72 8M 85	18F	St	72	3020	75	183,35	181,97	192		150	95	51	22	340	8,10
TL 80 8M 85	18	GG	80	3020	75	203,72	202,35			180	95	51	22		10,20
TL 90 8M 85	19	GG	90	3020	75	229,18	227,81		170	204	95	51	22		11,20
TL112 8M 85	19	GG	112	3020	75	285,21	283,83		170	254	95	51	22		15,00
TL144 8M 85	20	GG	144	3525	90	366,69	365,32		198	336	95	65	15		20,20
TL168 8M 85	20	GG	168	3525	90	427,81	426,44		198	395	95	65	15		22,40
TL192 8M 85	20	GG	192	3525	90	488,92	487,55		198	455	95	65	15		28,20



# POLEAS DENTADAS PARA TAPER PARA CORREAS SYNCHROBELT® - "HTD" SYNCHROBELT® "HTD" TIMING BELTS PULLEYS FOR TAPER BUSHES

## 14M

### PASO 14 mm

PARA ANCHO DE CORREA 40 mm

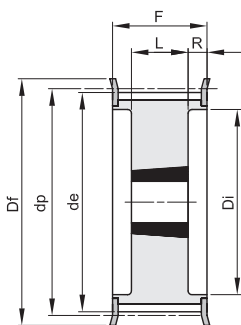

18F

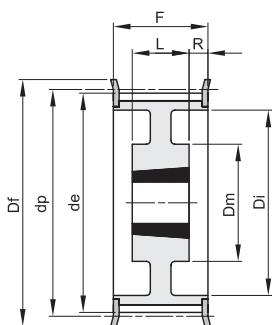

19F

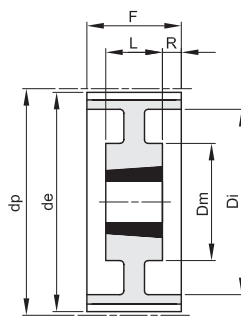

19

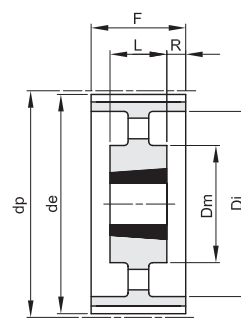

20

Material: Acero (St)

Material: Fundición (GG)

codice	tipo	materiale denti	bussola	foro max	dp	de	Df	Dm	Di	F	L	R	n° flangia	Kg.
TL 28 14M 40	18F	St	28	2012	50	124,78	122,12	127	94	54	32	11	400	2,10
TL 30 14M 40	18F	St	30	2012	50	133,69	130,99	138	98	54	32	11	401	2,70
TL 32 14M 40	18F	St	32	2012	50	142,60	139,88	154	108	54	32	11	403	3,40
TL 34 14M 40	18F	St	34	2517	60	151,52	148,79	160	110	54	45	4,5	404	3,90
TL 36 14M 40	18F	St	36	2517	60	160,43	157,68	168	120	54	45	4,5	405	4,80
TL 38 14M 40	18F	St	38	2517	60	169,34	166,60	183	130	54	45	4,5	406	5,40
TL 40 14M 40	18F	St	40	2517	60	178,25	175,49	188	138	54	45	4,5	407	6,00
TL 44 14M 40	18F	St	44	3020	75	196,08	193,28	211	155	54	51	1,5	411	7,50
TL 48 14M 40	18F	St	48	3020	75	213,90	211,11	226	170	54	51	1,5	412	8,50
TL 56 14M 40	18F	GG	56	3020	75	249,55	246,76	256	208	54	51	1,5	416	10,10
* TL 64 14M 40	19F	GG	64	3020	75	285,21	282,41	296	170	240	54	51	1,5	418
TL 72 14M 40	19	GG	72	3020	75	320,86	318,06	170	280	54	51	1,5		15,00
TL 80 14M 40	20	GG	80	3020	75	356,51	353,71	170	315	54	51	1,5		16,00
TL 90 14M 40	20	GG	90	3020	75	401,07	398,28	170	360	54	51	1,5		18,00
TL112 14M 40	20	GG	112	3020	75	499,11	496,32	170	457	54	51	1,5		25,50
TL144 14M 40	20	GG	144	3020	75	641,71	638,92	170	600	54	51	1,5		32,00
TL168 14M 40	20	GG	168	3020	75	748,66	745,87	170	706	54	51	1,5		43,50
TL192 14M 40	20	GG	192	3020	75	855,62	852,82	170	813	54	51	1,5		49,50

\* Costruite a richiesta - Manufactured on request.



# POLEAS DENTADAS PARA TAPER PARA CORREAS SYNCHROBELT® - "HTD"

## SYNCHROBELT® "HTD" TIMING BELTS PULLEYS FOR TAPER BUSHES

### 14M

PASO 14 mm

PARA ANCHO DE CORREA 55 mm

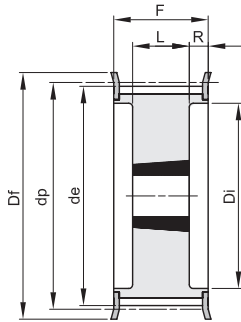

18F

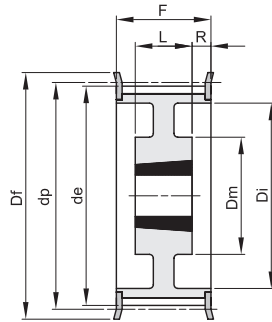

19F

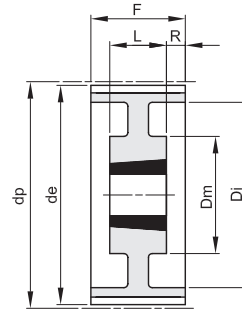

19

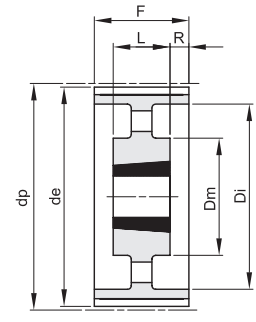

20

Material: Acero (St)

Material: Fundición (GG)

codice	tipo	materiale denti	bussola	foro max	dp	de	Df	Dm	Di	F	L	R	n° flangia	Kg.	
TL 28 14M 55	18F	St	28	2012	50	124,78	122,12	127	94	70	32	19	400	2,20	
TL 30 14M 55	18F	St	30	2517	60	133,69	130,99	138	100	70	45	12,5	401	2,70	
TL 32 14M 55	18F	St	32	2517	60	142,60	139,88	154	108	70	45	12,5	403	3,60	
TL 34 14M 55	18F	St	34	2517	60	151,52	148,79	160	110	70	45	12,5	404	4,50	
TL 36 14M 55	18F	St	36	2517	60	160,43	157,68	168	120	70	45	12,5	405	5,20	
TL 38 14M 55	18F	St	38	2517	60	169,34	166,60	183	130	70	45	12,5	406	6,20	
TL 40 14M 55	18F	St	40	2517	60	178,25	175,49	188	138	70	45	12,5	407	6,90	
TL 44 14M 55	18F	St	44	3020	75	196,08	193,28	211	155	70	51	9,5	411	8,60	
TL 48 14M 55	18F	St	48	3020	75	213,90	211,11	226	170	70	51	9,5	412	10,50	
TL 56 14M 55	18F	GG	56	3020	75	249,55	246,76	256	208	70	51	9,5	416	13,50	
TL 64 14M 55	19F	GG	64	3020	75	285,21	282,41	296	170	240	70	51	9,5	418	14,50
TL 72 14M 55	19	GG	72	3020	75	320,86	318,06	170	280	70	51	9,5		16,30	
TL 80 14M 55	20	GG	80	3020	75	356,51	353,71	170	315	70	51	9,5		17,50	
TL 90 14M 55	20	GG	90	3020	75	401,07	398,28	170	360	70	51	9,5		20,00	
TL112 14M 55	20	GG	112	3020	75	499,11	496,32	170	457	70	51	9,5		28,20	
TL144 14M 55	20	GG	144	3020	75	641,71	638,92	170	600	70	51	9,5		36,00	
TL168 14M 55	20	GG	168	3020	75	748,66	745,87	170	706	70	51	9,5		48,50	
TL192 14M 55	20	GG	192	3020	75	855,62	852,82	170	813	70	51	9,5		52,00	



# POLEAS DENTADAS PARA TAPER PARA CORREAS SYNCHROBELT® - "HTD"

## SYNCHROBELT® "HTD" TIMING BELTS PULLEYS FOR TAPER BUSHES

### 14M

#### PASO 14 mm

PARA ANCHO DE CORREA 85 mm

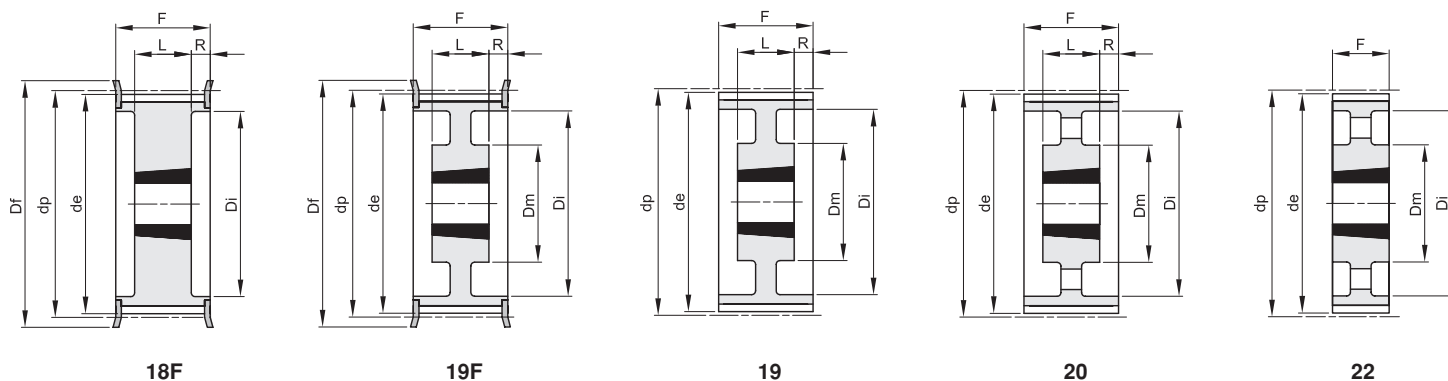

Material: Acero (St)

Material: Fundición (GG)

codice	tipo	materiale	denti	bussola	foro max	dp	de	Df	Dm	Di	F	L	R	n° flangia	Kg.
TL 28 14M 85	18F	St	28	2517	60	124,78	122,12	127		98	102	45	28,5	400	2,70
TL 30 14M 85	18F	St	30	2517	60	133,69	130,99	138		100	102	45	28,5	401	3,80
TL 32 14M 85	18F	St	32	2517	60	142,60	139,88	154		108	102	45	28,5	403	4,70
TL 34 14M 85	18F	St	34	2517	60	151,52	148,79	160		110	102	45	28,5	404	6,00
TL 36 14M 85	18F	St	36	3020	75	160,43	157,68	168		125	102	51	25,5	405	5,70
TL 38 14M 85	18F	St	38	3020	75	169,34	166,60	183		130	102	51	25,5	406	6,80
TL 40 14M 85	18F	St	40	3020	75	178,25	175,49	188		138	102	51	25,5	407	8,00
TL 44 14M 85	18F	St	44	3030	75	196,08	193,28	211		155	102	76	13	411	11,70
TL 48 14M 85	18F	St	48	3030	75	213,90	211,11	226		170	102	76	13	412	15,00
TL 56 14M 85	18F	GG	56	3525	90	249,55	246,76	256		210	102	65	18,5	416	19,00
TL 64 14M 85	19F	GG	64	3525	90	285,21	282,41	296	190	240	102	65	18,5	418	23,50
TL 72 14M 85	19	GG	72	3525	90	320,86	318,06		190	280	102	65	18,5		25,00
TL 80 14M 85	20	GG	80	3525	90	356,51	353,71		190	315	102	65	18,5		26,00
TL 90 14M 85	20	GG	90	3525	90	401,07	398,28		190	360	102	65	18,5		28,00
TL112 14M 85	20	GG	112	3525	90	499,11	496,32		190	457	102	65	18,5		36,00
TL144 14M 85	20	GG	144	3525	90	641,71	638,92		190	600	102	65	18,5		48,00
TL168 14M 85	20	GG	168	3525	90	748,66	745,87		190	706	102	65	18,5		60,00
TL192 14M 85	22	GG	192	4040	100	855,62	852,82		230	813	102	102			85,00



# POLEAS DENTADAS PARA TAPER PARA CORREAS SYNCHROBELT® - "HTD"

## SYNCHROBELT® "HTD" TIMING BELTS PULLEYS FOR TAPER BUSHES

### 14M

#### PASO 14 mm

PARA ANCHO DE CORREA 115 mm

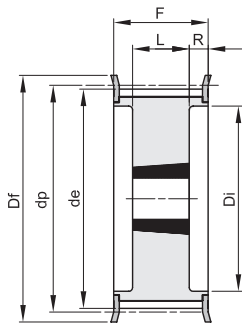

18F

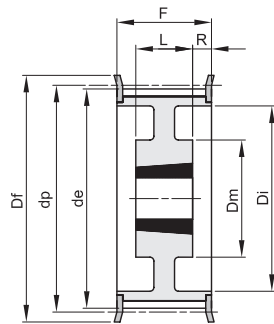

19F

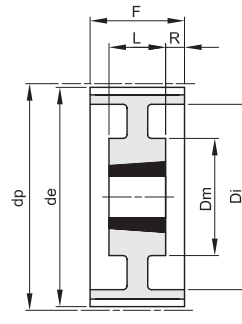

19

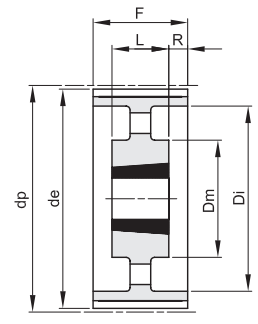

20

Material: Acero (St)

Material: Fundición (GG)

codice	tipo	materiale denti	bussola	foro max	dp	de	Df	Dm	Di	F	L	R	n° flangia	Kg.
TL 28 14M 115	18F	St	28	2517	60	124,78	122,12	127	98	133	45	44	400	3,80
TL 30 14M 115	18F	St	30	2517	60	133,69	130,99	138	100	133	45	44	401	5,00
TL 32 14M 115	18F	St	32	2517	60	142,60	139,88	154	108	133	45	44	403	6,80
TL 34 14M 115	18F	St	34	2517	60	151,52	148,79	160	110	133	45	44	404	6,90
TL 36 14M 115	18F	St	36	3020	75	160,43	157,68	168	125	133	51	41	405	7,00
TL 38 14M 115	18F	St	38	3020	75	169,34	166,60	183	130	133	51	41	406	8,50
TL 40 14M 115	18F	St	40	3020	75	178,25	175,49	188	138	133	51	41	407	9,10
TL 44 14M 115	18F	St	44	3030	75	196,08	193,28	211	155	133	76	28,5	411	13,00
TL 48 14M 115	18F	St	48	3030	75	213,90	211,11	226	170	133	76	28,5	412	16,00
TL 56 14M 115	18F	GG	56	3535	90	249,55	246,76	256	210	133	89	22	416	24,00
TL 64 14M 115	19F	GG	64	3535	90	285,21	282,41	296	190	240	89	22	418	32,00
TL 72 14M 115	19	GG	72	3535	90	320,86	318,06	190	280	133	89	22	418	31,00
TL 80 14M 115	20	GG	80	3535	90	356,51	353,71	190	315	133	89	22	418	32,00
TL 90 14M 115	20	GG	90	3535	90	401,07	398,28	190	360	133	89	22	418	37,00
TL112 14M 115	20	GG	112	3535	90	499,11	496,32	190	457	133	89	22	418	45,00
TL144 14M 115	20	GG	144	4040	100	641,71	638,92	230	600	133	102	15,5	418	63,00
TL168 14M 115	20	GG	168	4040	100	748,66	745,87	230	706	133	102	15,5	418	77,50
TL192 14M 115	20	GG	192	4040	100	855,62	852,82	230	813	133	102	15,5	418	95,00