

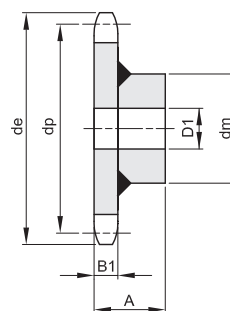

PIÑONES PARA CADENA TRANSPORTADORA

SPROCKETS FOR CONVEYOR CHAINS

PASO 50 RODILLO 25

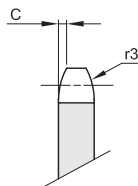

B1	C	r3
10,5	3	50

Material: Fe

Z	de	dp	dm	D1	A	Kg.
6	121,0	100,00	58	20	40,5	1,11
7	136,0	115,24	58	20	40,5	1,37
8	151,5	130,65	58	20	40,5	1,55
9	167,0	146,20	58	20	40,5	1,89
10	183,0	161,80	88	25	45,5	3,10
11	198,5	177,50	88	25	45,5	3,44
12	214,0	193,20	88	25	45,5	3,79
13	230,0	208,95	88	25	45,5	4,17
14	245,5	224,70	88	25	45,5	4,63
15	261,5	240,45	88	25	45,5	5,09
16	277,5	256,30	118	30	60,5	8,26
17	293,0	272,11	118	30	60,5	9,10
18	309,0	287,95	118	30	60,5	9,26
19	325,0	303,80	118	30	60,5	10,32
20	340,5	319,60	118	30	60,5	10,42

Z	de	dp	dm	D1	A	Kg.
21	356,5	335,45	118	30	60,5	11,71
22	372,5	351,35	118	30	60,5	12,20
23	388,0	367,20	118	30	60,5	12,47
24	404,0	383,05	118	30	60,5	13,00
25	420,0	398,95	118	30	60,5	13,98
28	467,5	446,55	133	30	62	18,62
30	499,5	478,35	133	30	62	20,29
35	579,0	557,80	133	30	62	24,57
38	626,5	605,45	133	30	62	26,97

PASO 50 RODILLO 31

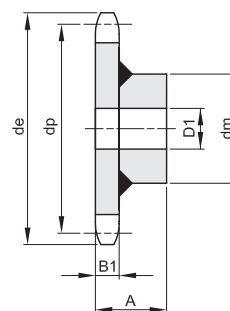
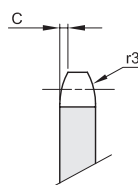

B1	C	r3
13,5	3	50

Material : Fe

Z	de	dp	dm	D1	A	Kg.
6	120,0	100,00	58	20	43,5	1,18
7	135,0	115,24	58	20	43,5	1,44
8	150,5	130,65	58	20	43,5	1,72
9	166,0	146,20	58	20	43,5	2,05
10	182,0	161,80	88	25	48,5	3,40
11	197,5	177,50	88	25	48,5	3,80
12	213,0	193,20	88	25	48,5	4,30
13	229,0	208,95	88	25	48,5	4,78
14	244,5	224,70	88	25	48,5	5,37
15	260,5	240,45	88	25	48,5	5,98
16	276,5	256,30	118	30	63,5	9,05
17	292,0	272,11	118	30	63,5	9,60
18	308,0	287,95	118	30	63,5	10,30
19	324,0	303,80	118	30	63,5	11,10
20	339,5	319,60	118	30	63,5	11,90

Z	de	dp	dm	D1	A	Kg.
21	355,5	335,45	118	30	63,5	12,75
22	371,5	351,35	118	30	63,5	13,54
23	387,0	367,20	118	30	63,5	14,38
24	403,0	383,05	118	30	63,5	15,35
25	419,0	398,95	118	30	63,5	16,40
26	435,0	414,80	133	30	65	18,81
28	466,5	446,55	133	30	65	21,00
30	498,5	478,35	133	30	65	23,42
32	530,0	510,10	133	30	65	25,93
38	625,5	605,45	133	30	65	32,10



PIÑONES PARA CADENA TRANSPORTADORA

SPROCKETS FOR CONVEYOR CHAINS

PASO 50,8 RODILLO 30

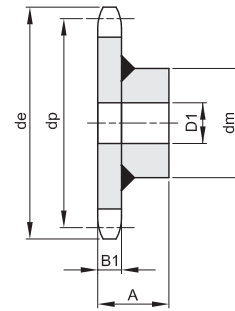
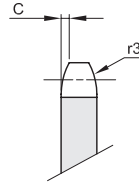

B1	C	r3
8,8	3	50

Material : Acero C 43

Z	de	dp	dm	D1	A	Kg.
8	149,0	132,74	58	20	39	1,35
10	182,0	164,39	88	25	44	2,85
12	214,0	196,27	88	25	44	3,37
14	247,0	228,29	88	25	44	4,08
16	279,0	260,39	118	30	59	7,34

Z	de	dp	dm	D1	A	Kg.

PASO 75 RODILLO 25

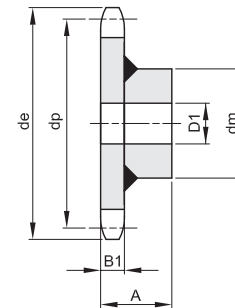
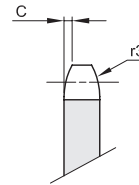

B1	C	r3
10,5	3	50

Material : Fe

Z	de	dp	dm	D1	A	Kg.
8	211,0	195,98	88	25	45,5	4,07
10	258,0	242,70	118	25	60,5	7,87

Z	de	dp	dm	D1	A	Kg.

PASO 75 RODILLO 31

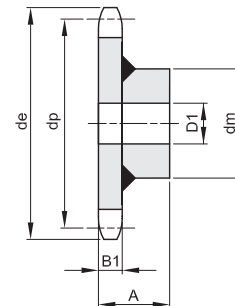
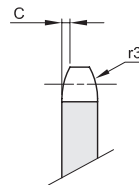

B1	C	r3
13,5	3	50

Material : Fe

Z	de	dp	dm	D1	A	Kg.
6	168,0	150,00	88	25	48,5	3,26
8	215,0	195,98	88	25	48,5	4,52
9	238,0	219,30	88	25	48,5	5,36
10	261,0	242,70	118	30	63,5	8,70
11	286,0	266,25	118	30	63,5	9,60
12	309,0	289,80	118	30	63,5	10,73

Z	de	dp	dm	D1	A	Kg.
13	333,0	313,42	118	30	63,5	11,83
14	357,0	337,05	118	30	63,5	13,15
15	380,0	360,73	118	30	63,5	14,45
16	404,0	384,45	133	30	65	17,43
20	499,0	479,40	133	30	65	23,80
21	523,0	503,17	133	30	65	26,07

